

## COVID Testing Instructions

**Step 1: Ensure you have not had any food or drink, not even water within the last 30 minutes (if so, notify the coordinator and plan to return)**



NO FOOD  
OR DRINK



**Step 2: Open the test package and remove items (have somewhere to layout items)**



**Step 3: Take the long specimen tub with the funnel on the top and fill with saliva up to the black line**



**Step 4: Remove the funnel and replace with the cap filled with blue liquid, secure tightly (blue liquid will automatically drain into the main tub)**

**Step 5: Shake for 5 seconds to mix the blue liquid and saliva**

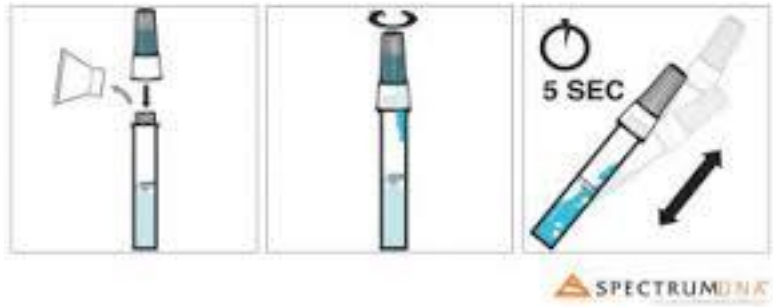

**Step 6: Place the specimen tub in the zip lock compartment of the specimen bag and seal (ensure it is closed)**



**Step 7: Discard all test items into the designated trashcan and exit the testing area**

